

Module - Park Assist - Front (Remove and Install)

FRT No: 17151002

Removal

1. Remove LH side rear trunk trim for access ([refer to procedure](#))
2. Working in LH side of rear trunk, remove nuts (x4) securing park assist module bracket to body.
3. Release park assist module bracket from body.

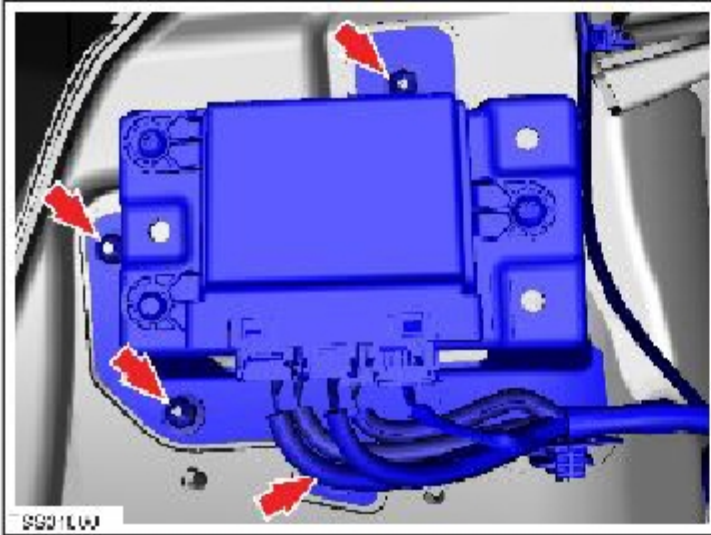

4. Disconnect park module harness connectors (x3).

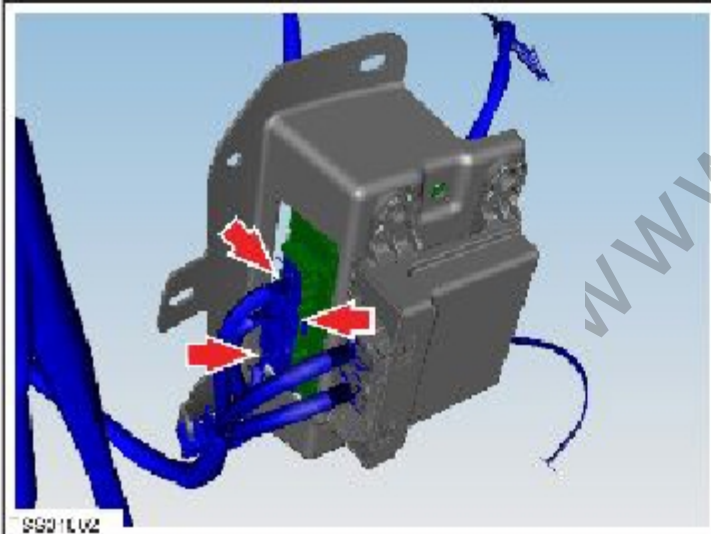

5. Remove screws (x3) securing front park assist module to bracket.

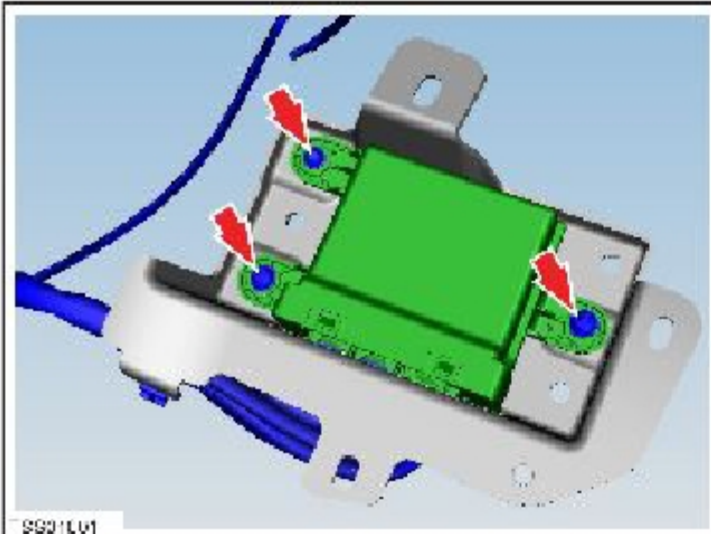

6. Remove front park assist module.



Installation

Installation procedure is the reverse of removal.

www.car60.cc

Module - Park Assist - Rear (Remove and Install)

FRT No: 17151102

Removal

1. Remove LH side rear trunk trim for access ([refer to procedure](#))
2. Working in LH side of rear trunk, remove screws (x3) securing rear park assist module to bracket.
3. Disconnect rear park assist module harness connectors (x2).

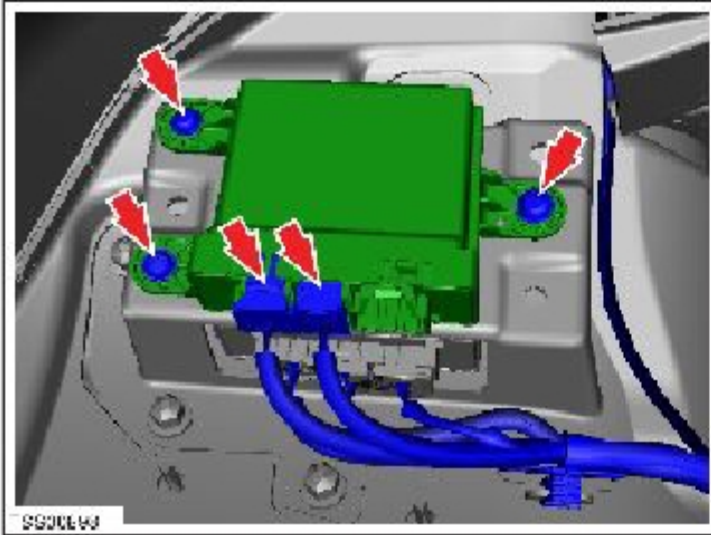

4. Remove rear park assist module.

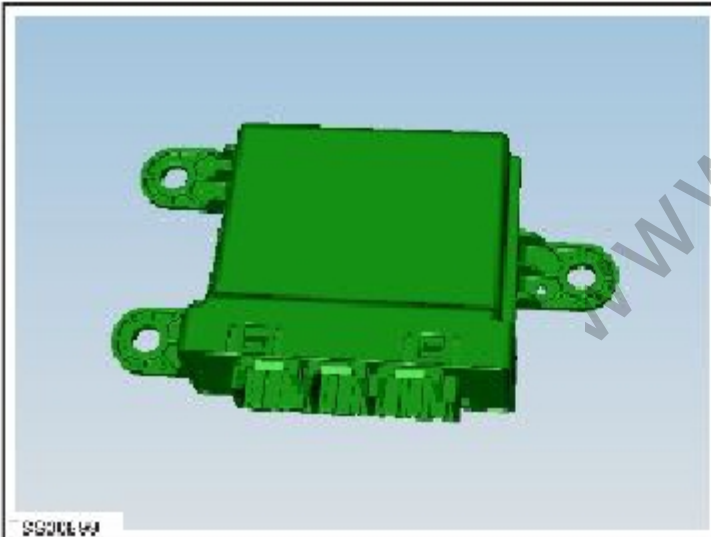

Installation

Installation procedure is the reverse of removal.